

TerraGator



TERRAGATOR

TG9300C TERRAGATOR CHASSIS (2019)

Parts and Service Guide

ZIEGLER
AG EQUIPMENT

TERRAGATOR Specifications*

ENGINE

Make	AGCO Power
Type	AP98-4
Number of Cylinders	7
Displacement	9.8 L (598 CID)
Horsepower	425 HP (317 kW) @ 2,100 rpm
Peak Horsepower	452 HP (337 kW) @ 1,900 rpm
Torque	1,416 ft-lb (1,921 N-m) @ 1,500 rpm

TRANSMISSION

Type	AGCO ML-260 Continuously Variable Transmission
Forward Speed (high/low)	41 mph / 21 mph (66 kmh / 34 kmh)

AXLES

Front	5-in. diameter (12.7 cm) freewheeling, cold-rolled solid steel
Rear	Double reduction, outboard planetary 54,000-lb rating with floatation tires

DRY SYSTEM

AirMax Precision**	Single bin, 355 cu.ft. (10.1 m ³)
AirMax Precision 2**	Adjustable, split bin, 345 cu.ft. (9.8 m ³)
Soilection Twin Bin***	Two bins, 320 cu.ft. (9.1 m ³)
Soilection Four Bin***	Four bins, 340 cu.ft. (9.6 m ³)
New Leader NL4500	Single bin, MultiApplier insert, MultiBin, up to 331 cu.ft. (9.3 m ³)
New Leader NL5000	Single bin, MultiApplier insert, MultiBin, up to 331 cu.ft. (9.3 m ³)

LIQUID SYSTEM

Capacity	2,400 gal. (9,885 L)
Pump	280 GPM (1,060 LPM) 450 GPM (1,703 LPM) 800 GPM (3,028 LPM)
Booms	60/80 ft. (18/24 m) fold-over boom 80 ft. (24 m)
Breakaway, Full Boom	Hydraulic, resettable
Breakaway, Boom Tip	Mechanical, spring return
Height / Tilt Adjustment	Hydraulic
Nozzle Spacing	30 in. (0.76 m) or 60 in. (1.52 m)
Total Spray Width	82.5 ft. (25.1 m) on 30 in. centers; 85 ft. (25.9 m) on 60 in. centers

AIR SYSTEM

Compressor	Engine-mounted
Governor	120 psi (8.2 bar)
CFM	14.1 cfm (6.7 L/s)
Reservoir	Dual

WEIGHTS

Rated Capacity Front	14,000 lbs. (6,350 kg)
Rated Capacity Rear	54,000 lbs. (24,494 kg)

SUSPENSION

Type	Rigid rear axle to frame mount
------	--------------------------------

STEERING

Type	Dynamic load sense
------	--------------------

TIRES

Standard	Goodyear® Optiterra Radial
Optional	Michelin® Radial 1050/50R32

APPLICATION CAB

Glass Area / Floor Area	58 sq.ft. (5.4 m ²) / 14 sq.ft. (1.39 m ²)
Cab Suspension	Air-ride cab
Radio	AM/FM / stereo USB MP3-compatible weather band Bluetooth® with mic. Opt. SiriusXM®
HVAC / Filtration	Automatic temperature control 3-level activated carbon
Standard Seat	Cloth with air-ride suspension
Optional Seat	Leather heated-vented with air-ride suspension

FLUID CAPACITIES

Fuel	200 gallon (757 L)
Diesel Exhaust Fluid (DEF)	20 gallon (75.7 L)
Engine Coolant	7.6 gallon (28.8 L)
Engine Oil	8.5 gallon (32 L)
Transmission Oil	14 gallon (53 L)
Hydraulic Reservoir	9 gallon (34 L)

CONTROLLERS

Controllers Available	Raven Viper 4+
-----------------------	----------------

* Specifications are manufacturer's estimates at time of publication and are subject to change without prior notification. Actual weight will vary depending on optional equipment.

** Single 40 cu.ft. (1.13 m³) granular bin available

*** Dual 25 cu.ft. (0.7 m³) granular bins available

TERRAGATOR Parts List

ITEM	PART NUMBER	QTY	DESCRIPTION	TECHNICAL SPECIFICATION
1	568310D1	1	Air Filter Element – Primary Air Filter	
2	568311D1	1	Air Filter Element – Safety	
3	72311028	1	Filter Element – Transmission High Pressure	
	72312070	1	Oil Filter Element – Transmission Suction	
4	AG520617	1	Suction Strainer – Hydraulic	2.5"
5	532430D1	1	Filter Element – Hydraulic	
6	556653D1	1	Cab Filter	
7	556654D1K	1	Cab Filter – Carbon	
8	AG718281	1	Air Filter Element – Cab	Particle
9	V836379588	1	Engine Oil Filter	
10	AG524540	1	Inline Strainer	100 Mesh
11	V837091129	1	Fuel Filter Kit	
	3905873M91	1	Fuel Filter Element – Water Separator	
12	567109D1	1	Belt – A/C Belt	1218 mm
	V685122255	1	Multi-Ribbed Belt – Fan Belt	
13	V837079423	1	DEF Filter	
14	AG330202	1	Filter – Air Dryer	

TO ORDER:

Call or visit your nearest Ziegler location. Visit www.zieglercat.com/contact for a directory.

TERRAGATOR Machine Diagram

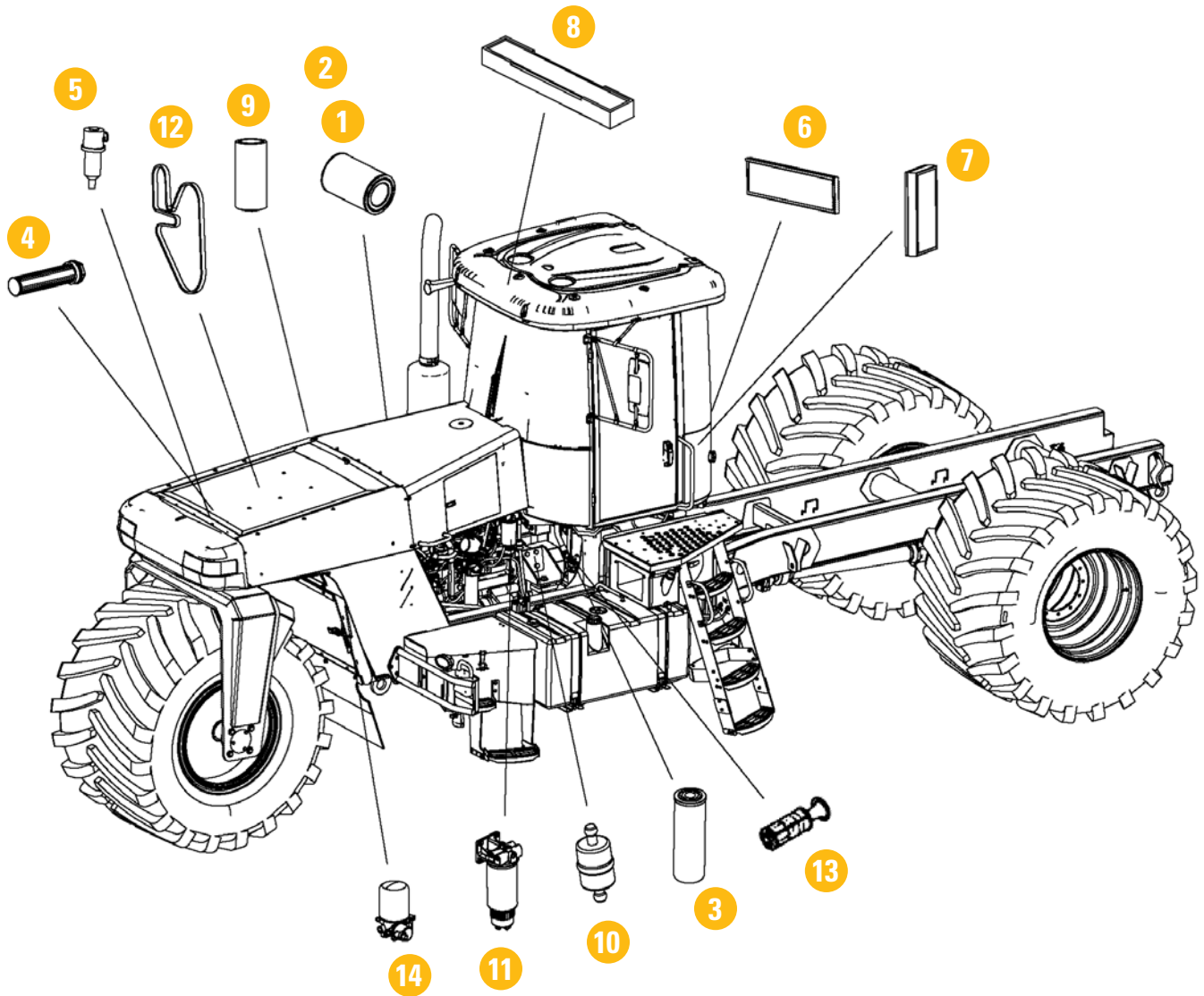

TERRAGATOR Service Guide

SERVICE ITEMS	INTERVAL										PARTS AND LUBRICANTS		
	Initial 100	100	250	400	500	800	1000	2000	Annual	Comprehensive	Part # / Charge Code	Qty	Description
Clean the cooling system (from outside)	X	X		X	X	X	X	X		X			
Check the condition of the belt	X	X		X	X	X	X	X		X			
Change the engine oil and filter				X		X		X	X	X	V837074523 79035456 SAMPLE	1 2 1	Engine Oil Filter Semi Synthetic SAE 10W-40 API- 5 GAL Sample
Change the fuel filters						X			X	X	V837091129 3905873M91	1 1	Fuel Filter Kit Fuel Water Separator
Check/administer engine software update				X		X		X		X			
Check the torque on rear and front wheel nuts	X	X		X	X	X	X	X		X			
Check the torque on the charge air hose clamps and hose from the turbo to the CAC	X							X	X	X			
Replace the inline fuel strainer	X							X	X	X	AG524540	1	Inline Strainer
Lubricate the tag axle fittings (if equipped)	Service Item not included in PM – create separate segment for service												
Lubricate front wheel bearings	X	X	X	X	X	X	X	X		X	79017915	1	MOLY EP Grease
Check the rear axle mounting bolts, tighten to torque of 424 lbf ft	X							X	X	X			
Check brake air lines	X	X	X	X	X	X	X	X		X			
Replace the hydraulic oil filter	X							X	X	X	587603D1	1	Hydraulic Filter
Replace the hydraulic oil								X	X	X		14	AGCO 821XL 10W-30 PERMATRAN GAL Sample
Replace the CVT high pressure filter	X							X	X	X	72311028 72313495	1 1	High Pressure Filter O-Ring
Replace the pressure washer pump oil	X				X		X	X	X	X			See lubricant table below
Check front and rear cab mounts	X	X		X	X	X	X	X		X			
Lubricate the steering cylinder ends	X	X		X	X	X	X	X		X	79017915	1	MOLY EP Grease
Drain the water and sediment out of the fuel tank	X	X		X	X	X	X	X		X			
Check the differential and planetary oil level	X	X		X	X	X		X					
Clean the differential breather	X	X		X	X	X	X	X		X			
Replace the differential and planetary oil								X	X	X	79014722 SAMPLE	4 3	AGCO Gear Lubricant/ Axle Oil 2.5 GAL Samples
Check the tag axle bearing bolt torque (if equipped)	Service Item not included in PM – create separate segment for service												
Check brakes manual slack adjusters (if equipped)	Service Item not included in PM – create separate segment for service												
Inspect and clean the cab air filters			X		X		X	X					
Lubricate grease fittings on driveline			X		X		X	X		X	79014728	1	Multi-Purpose Lithium II Grease
Check the clutch master cylinder fluid; check for correct operation				X		X		X		X			
Replace the air dryer filter					X		X	X		X	AG330202	1	Air Dryer Filter
Lubricate the brake slack adjuster on rear axle					X		X	X		X	79017915	1	MOLY EP Grease
Check the engine-to-frame ground connections					X		X	X		X			
Check driveline U-joints					X		X	X		X			
Replace the receiver-dryer (A/C system)							X	X	X	X	593052D2	1	A/C Receiver Drier
Replace the primary engine air filter							X	X	X	X	568310D1	1	Primary Engine Air Filter
Replace the pressure washer strainer							X	X	X	X	AG513640	1	Inline Pressure Washer Strainer
Replace the cab air filters									X	X	556653D1 556654D1K AG718281	1 1 1	Cab Filter Cab Carbon Filter Particle Filter

LUBRICANTS

Component	Oil type/Class	Viscosity	US GAL	# of Components	Part # / Charge Code	Description
Rear axle differential and planetary	GL-5	80W-90	8.6	1	79014722	AGCO Gear Lubricant/ Axle Oil 2.5 GAL
Hydraulic system	Permatran 821XL	10W-30	14	1		AGCO 821XL 10W-30 PERMATRAN GAL
Transmission	Permatran 821XL PLUS	15W-40	15.1	1		AGCO 821XL PLUS 15W-40 TRAN OIL GAL
Engine oil	CJ-4	10W-40	8.5	1	79035456	Semi Synthetic SAE 10W-40 API 5 GAL
Grease fittings	high temp moly-lithium base grease			1	79017915	MOLY EP Grease
Pressure wash pump	NON-Detergent oil	30W	0.0935	1		
Grease fittings on driveline	high temp NLGI #2 multi-purpose moly-free lithium grease				79014728	Multi-Purpose Lithium II Grease
CVT clutch oil	Pentosin CHF 11S					
Engine coolant	50/50 water & ethylene glycol without stop leak additive with SCA	50/50	7.6	1	ZXRU1	PREMIX COOLANT