

# VIRNIG

## Pallet Fork Grapple

Specifications

MODEL	PFG48
A) Overall Width	54.75 in.
B) Overall Depth	56.25 in.
C) Overall Height, Closed	38.13 in.
D) Minimum Closed Diameter	22.25 in.
E) Overall Height, Open	56.13 in.
F) Jaw Opening	47.25 in.
G) Jaw Width	21.63 in.
H) Tine Length	48.0 in.
I) Tine Thickness	1.75 in.
J) Minimum Tine Space	8.94 in.
K) Maximum Tine Space	49.06 in.
Approximate Weight	850 lb.
Capacity	6200* lb.
End Plates	3/8" High Tensile Plate
Grapple Forks	1/2" High Tensile Plate
Grapple Pins	1.25 in. 1045 Round
Cylinder Specifications	
Bore	2.0 in.
Stroke	8.38 in.
Rod Diameter	1.25 in.
Cylinder Pin Diameter	1.25 in.

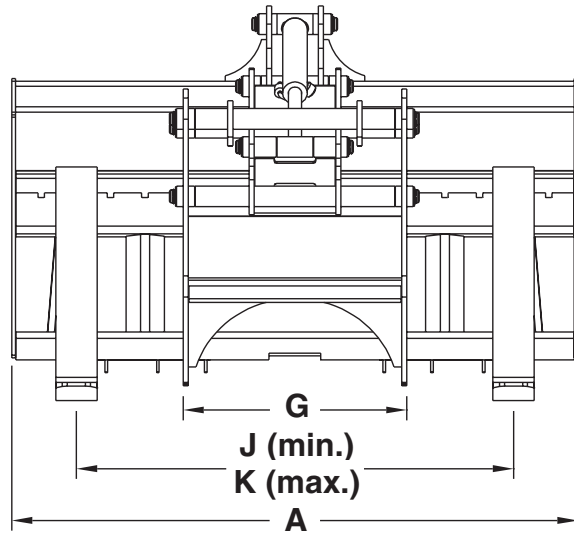

*\*With Load Center 24" from Frame.*

**Forged Solid Tines.**

**Includes Hoses From Attachment To Skid Loader.  
Couplers Available Upon Request.**

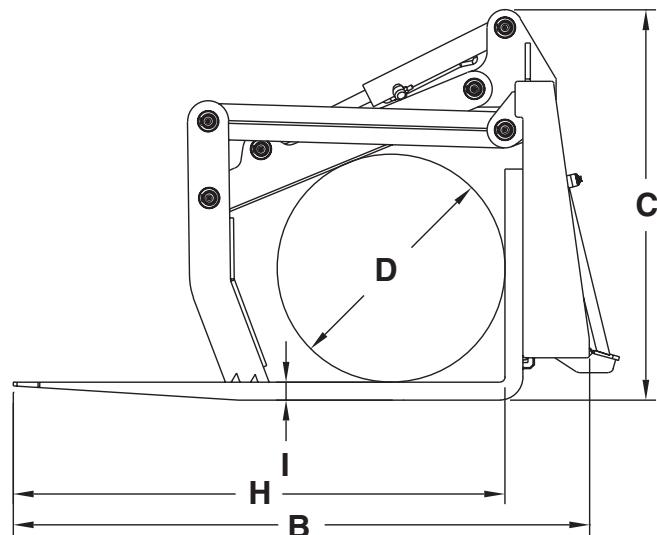
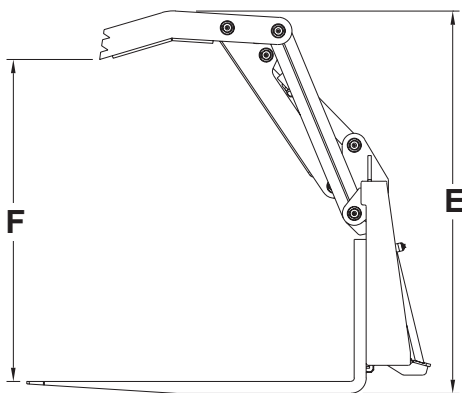

DISTRIBUTED BY:

**Specifications and designs are subject  
to change without notice.**

Virnig Manufacturing, Inc  
800-648-2408  
www.virnigmfg.com